



“WE MAKE THE KITCHEN BETTER!”

ATOSA USA, INC.

Toll Free: 855-855-0399 Email: info@atosausa.com

www.atosa.com | www.atosausa.com

California, Colorado, Florida, Georgia, Illinois, New Jersey, Ohio, Texas, Washington

Standard Top Sandwich Prep Tables

Standard Features

- Stainless steel exterior & interior
- Rear mount compressor with environmentally friendly R290 refrigerant
- Concentrated airflow design for even distribution of airflow around pans. Unmatched cabinet airflow design
- Electronic Temperature Controller
- Removable stainless steel pan liner
- Maintains temperatures between 35°F – 38°F
- Locking divider bars
- Pre-installed 6” deep poly pans
- 9-1/4” cutting board
- Recessed door handle(s)
- Self-closing door(s) with stay open feature
- Magnetic door gasket(s) standard for positive door seal
- One(1) pre-installed shelf per section
- Pre-installed casters

Optional Accessories

- Double overshelf for 27”, 36”, 48”, 60” and 72” models
- Part # 82021902 - 12” cross bar
- Night covers



Models	Dimensions	Weight Capacity (lb)
MROS-2RE	12 ^{1/2} ×27	150
MROS-3RE	12 ^{1/2} ×36	170
MROS-4RE	12 ^{1/2} ×48	200
MROS-5RE	12 ^{1/2} ×60	230
MROS-6RE	12 ^{1/2} ×72	250

For the best results of food preservation we recommend setting your refrigerator between 35°F to 38 °F

1. Don't forget to leave the unit some room to breathe!
2. Please clean the condenser frequently to give the unit more fresh air.



2 YEAR PARTS AND LABOR WARRANTY
5 YEAR COMPRESSOR PART WARRANTY

MODELS:

MSF8301GR / MSF3610GR
MSF8302GR / MSF8303GR / MSF8304GR



MSF8301GR



MSF3610GR



MSF8302GR



MSF8303GR



MSF8304GR





"WE MAKE THE KITCHEN BETTER!"

ATOSA USA, INC.

Toll Free: 855-855-0399 Email: info@atosausa.com

www.atosa.com | www.atosausa.com

California, Colorado, Florida, Georgia, Illinois,
New Jersey, Ohio, Texas, Washington

SPECIFICATIONS

Models	Door	Capacity (Cu.Ft.)	Shelves	Casters (inch)	Amps (A)	Voltage (V/Hz/Ph)	HP	Refrigerant	Exterior Dimensions (inch)	Net Weight (lb)	Gross Weight (lb)
MSF8301GR	1	7.2	1	2	2.3	115/60/1	1/7	R290	27 ^{1/2} ×30×41 ^{3/8}	159	196
MSF3610GR	2	8.7	2	2	2.3	115/60/1	1/7	R290	36 ^{5/16} ×30×41 ^{3/8}	173	227
MSF8302GR	2	13.4	2	2	2.3	115/60/1	1/7	R290	48 ^{1/5} ×30×41 ^{3/8}	231	276
MSF8303GR	2	17.2	2	2	2.8	115/60/1	1/5	R290	60 ^{1/5} ×30×41 ^{3/8}	271	320
MSF8304GR	3	21.1	3	2	2.8	115/60/1	1/5	R290	72 ^{7/10} ×30×41 ^{3/8}	317	379

PLAN VIEW

MSF8301GR

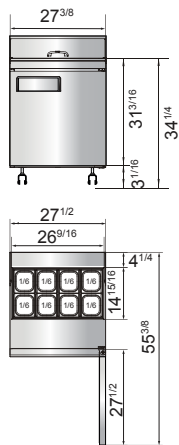

MSF3610GR

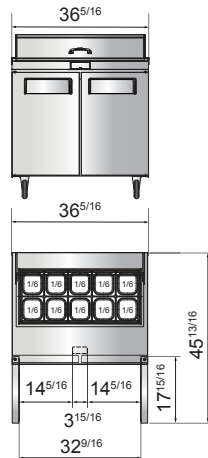

MSF8302GR

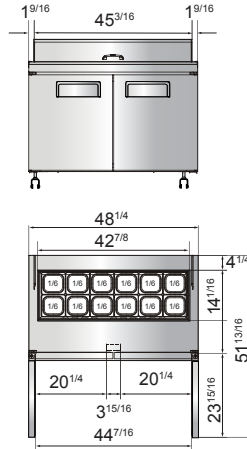

SIDE VIEW

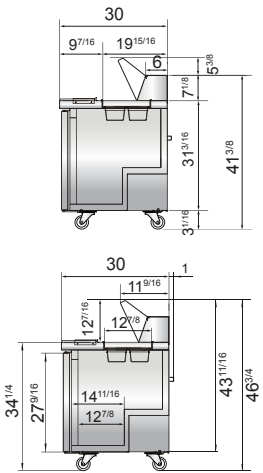

MSF8303GR

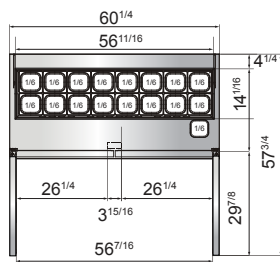
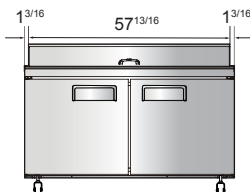

MSF8304GR

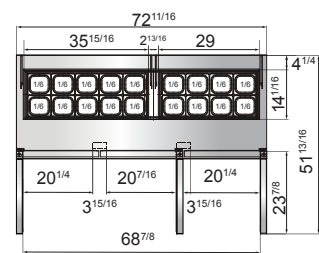
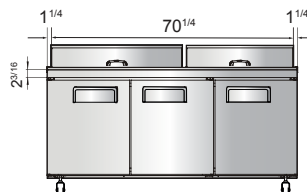

Stainless steel pan liner

Concentrated airflow design for even distribution of airflow around pans

Unmatched cabinet airflow design

Locking divider bars

